



# COMUNE DI RAGUSA

**RICHIESTA OCCUPAZIONE SUOLO PUBBLICO IN C.SO XXV APRILE  
PER LA SOMMINISTRAZIONE DI ALIMENTI E BEVANDE - DITTA ESSE ACCA SRLS  
Settore 1: Giardini Iblei - Isolato n.14 - Unità edilizia 8**

## DITTA PROPRIETARIA

### ESSE ACCA SRLS

Sede Legale: via E. Berlinguer n. 1 - 97100 Ragusa

Sede Operativa: C.so XXV Aprile n. 84 e n.88 - 97100 Ragusa

P.IVA 01609220883

## IL TECNICO

### Arch. Pian. Carbonaro Alessandro

via San Luca n.16 - Ragusa

C.F. CBR LSN 81D21 H163D

P.I. 01476100886



TAV.	SCALA	CONTENUTO	DATA
Unica	1:50	INQUADRAMENTO URBANISTICO PLANIMETRIE	05-02-2019



ESTRATTO ORTOFOTO SATELLITARE - DEL COMUNE DI RAGUSA

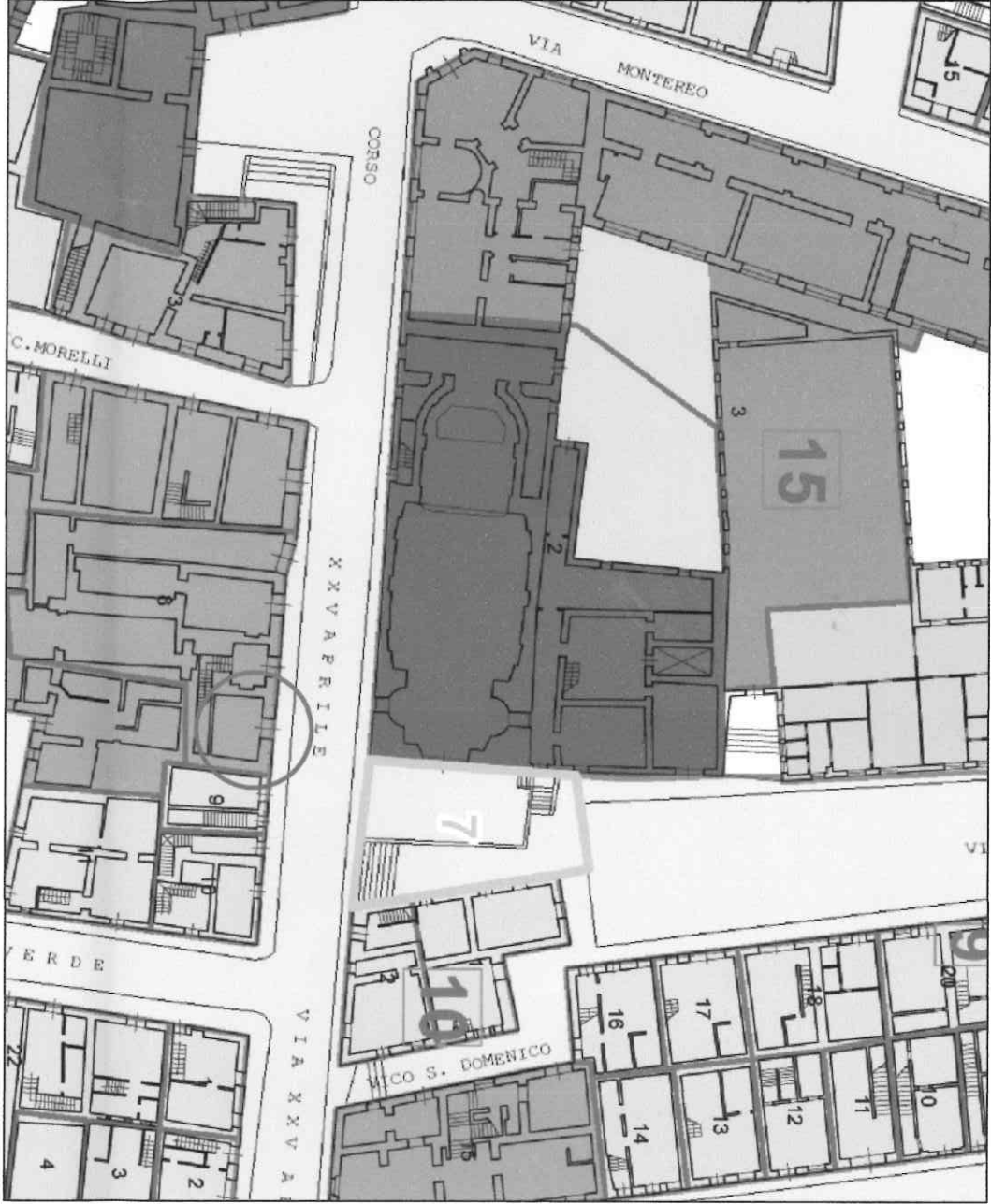

ESTRATTO PRGC DEL COMUNE DI RAGUSA SCALA 1:500

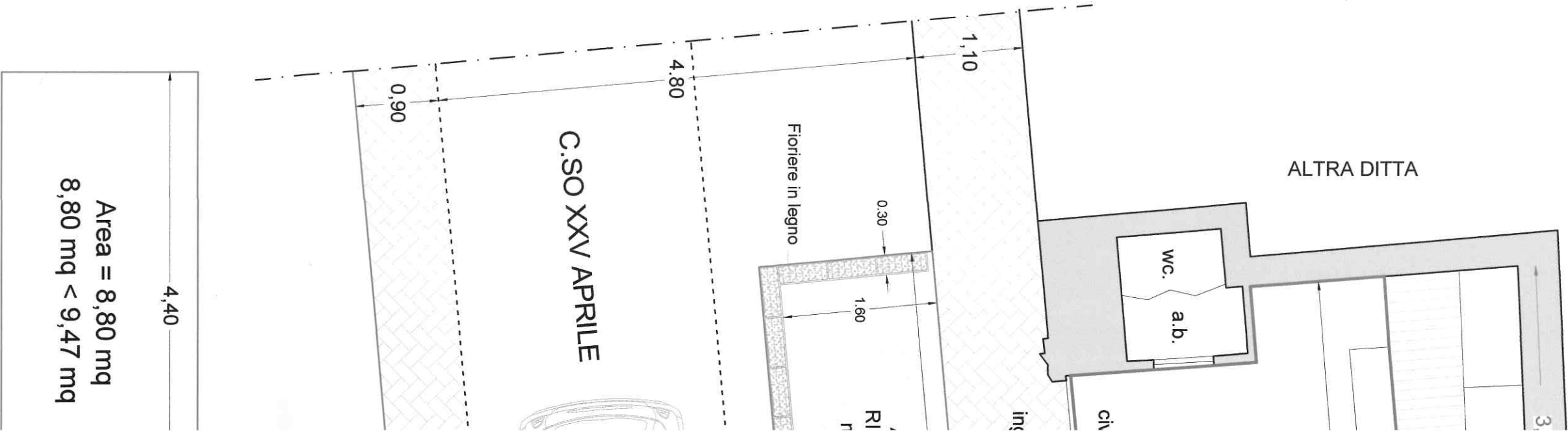

Pianta ingombro area richi

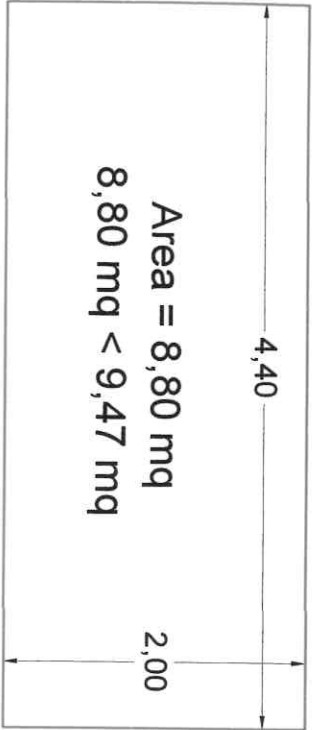
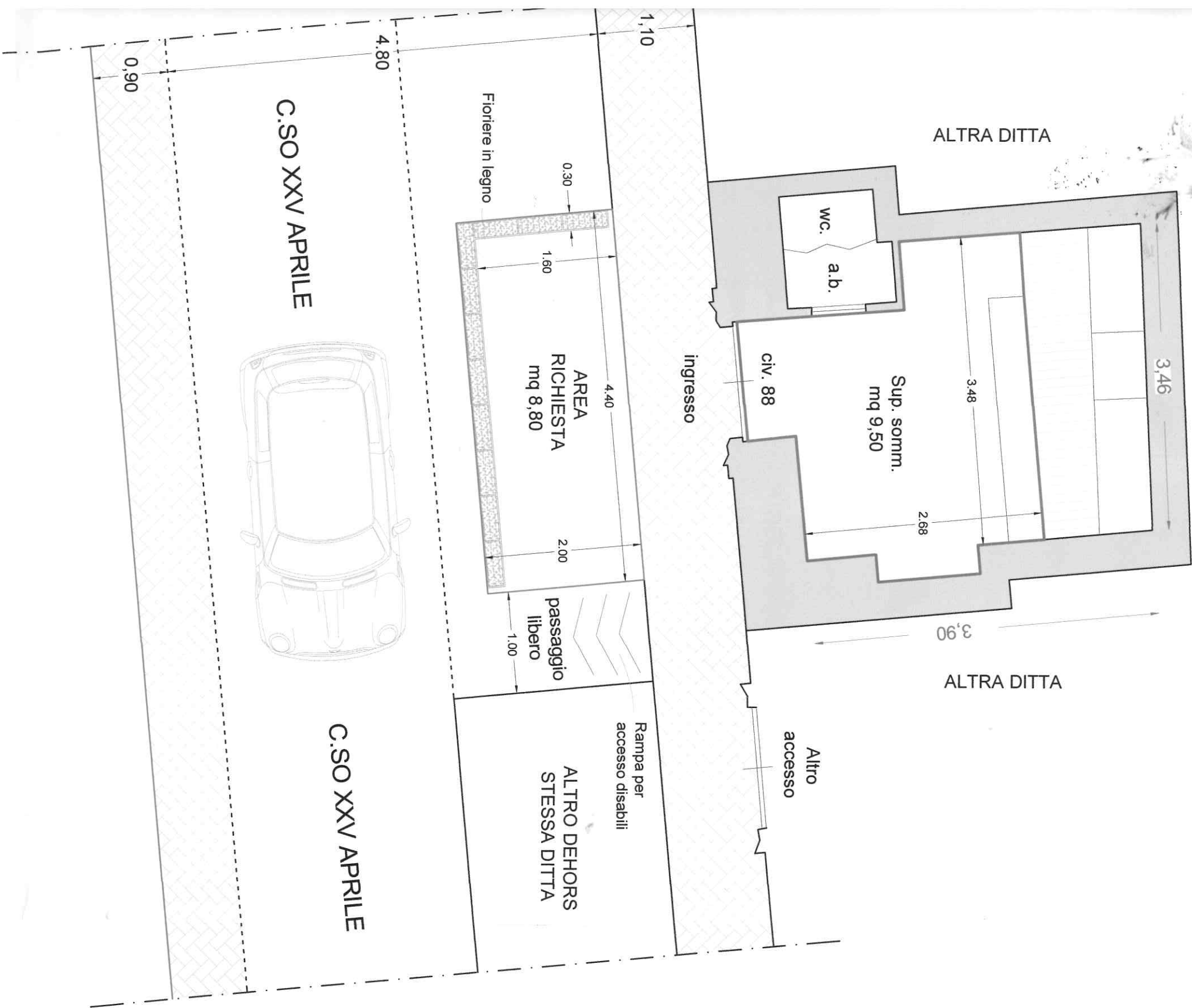

Pianta ingombro area richiesta

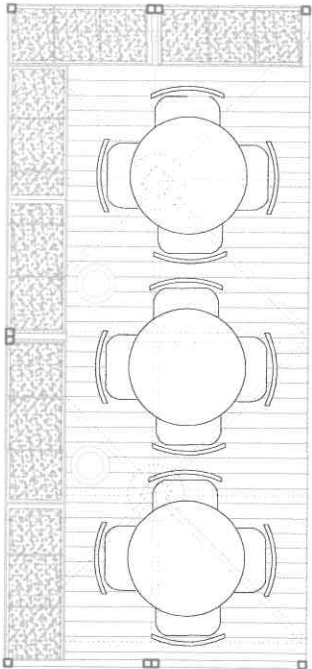

Pianta Arredi tipo dehors



Foto n.1 - vista vers  
50

Es. con pannello  
laterale in plexiglass

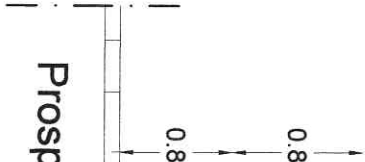

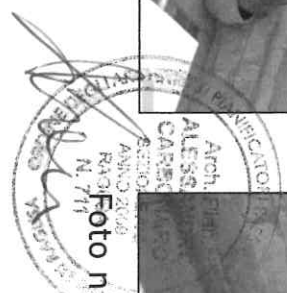
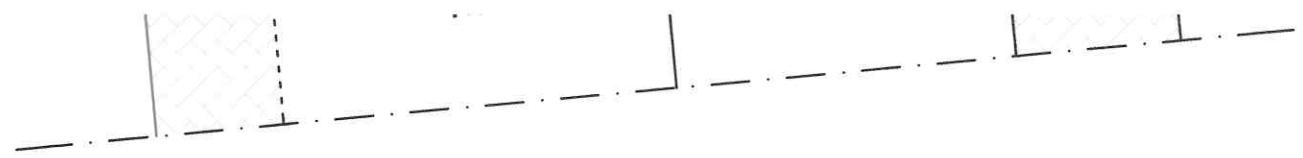

50 C-50 XXU AMW

SU C-50 XXU APR 21 1965



Figure 1: Schematic diagram of the room layout. The room is rectangular, with dimensions 10m by 10m. The room is divided into four quadrants by a central horizontal line. The top-left quadrant is labeled 'A' and contains a 'Speaker' and a 'Microphone'. The top-right quadrant is labeled 'B' and contains a 'Speaker' and a 'Microphone'. The bottom-left quadrant is labeled 'C' and contains a 'Speaker' and a 'Microphone'. The bottom-right quadrant is labeled 'D' and contains a 'Speaker' and a 'Microphone'. The room is labeled 'Room' and has a 'Door' on the right wall. The diagram is labeled 'Figure 1' and 'Figure 1: Schematic diagram of the room layout'.

\*Ante laterali superiori da cm 80 rimovibili  
coperture laterali per periodo invernale